

ASL-3000R

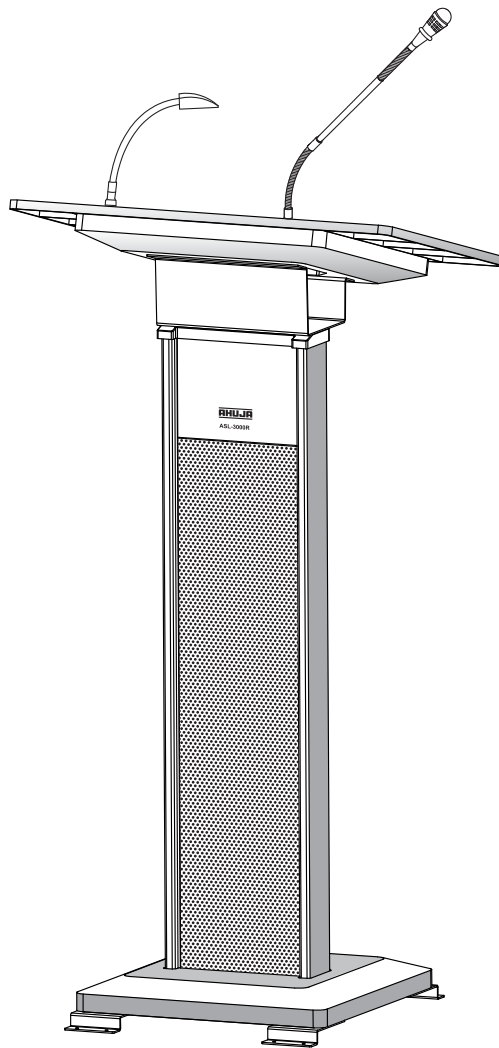

- ◆ Thank you for purchasing the AHUJA PA Lectern System.
- ◆ Please read this manual thoroughly before making connections and turning ON the power. Following the instructions in this manual will enable you to obtain optimum performance from your new AHUJA PA Lectern System.
- ◆ Please retain this manual for future reference.

• Safety Instructions

Read the Instructions: Please read all the instructions in this section carefully before installation or use of the product. All the safety instructions must be followed.

Retain the Instructions: Please retain this Instruction Manual for future reference.



This symbol, wherever it appears, alerts you to the presence of uninsulated hazardous voltage that may be sufficient to constitute a risk of electric shock. External wiring to any terminal marked with this symbol must be done by a trained and instructed person only.



This symbol, wherever it appears adjacent to a component, alerts you that the concerned component can only be replaced by another of the exact same specifications.

WARNING

- To reduce the risk of electric shock, do not open the product. No user serviceable parts inside. Refer all servicing to qualified personnel only.
- Before replacing any fuse, make sure the set is switched off and disconnected from the AC mains or any other power source. Replace a fuse only with another of exactly same specification.

CAUTIONS

Water & Moisture: To reduce the risk of fire or electrical shock, do not expose this product to rain or moisture. Do not use this product near water or in a wet location. Do not keep any object filled with liquid, such as a vase, on top of this set. Do not insert or remove the AC mains plug with wet hands.

Power Source: The voltage & frequency of the AC mains supply, to which this set can be connected, is marked on the rear panel of the set. Do not connect this set to any power source other than those specified on the rear panel.

Power Cord Protection: Do not cut, kink, damage or modify the AC power cord supplied with this set. Keep the AC power cord away from heaters and harmful chemicals. Do not keep any heavy object on the power cord.

Operation on Generator: When operating this set on a generator, make sure the set is switched off till the generator voltage has stabilized.

Stability: This set must be kept in a stable and flat horizontal position, and never in a tilted position. Do not place this set on an unstable stand, tripod, bracket or mount. Do not use attachments which are not supplied or explicitly recommended by the manufacturer.

Cleaning: Disconnect this equipment from the AC mains before cleaning. Clean with a damp cloth, but do not allow any liquid to enter the equipment. Do not clean with liquids or aerosols.

• Table of Contents

Contents	Page No
● Features and General Description of Product	4
● Instructions for Product Assembly	5
● Various Parts of lectern & their Functions	7
● Terminal Plate - Parts & Functions	8
● Handheld Transmitter Controls and Features	10
● Description of Various Functions	11
● Specifications	12

• Features/General Description of Product

- Compact, reliable and easy-to-assemble PA Lectern System with built-in 90W Class D amplifier.
- Supplied with a 460mm (18") detachable gooseneck condenser microphone and a reading light, for the podium top.
- Contains a built-in Dual Channel VHF wireless receiver and two nos. of VHF wireless handheld transmitters of different frequency.
- Fitted with 3 nos. of 6.5" (165mm) coated dual cone speakers. Provision given for connecting external speaker, through an INT./EXT. speaker switch.
- Combo socket for connecting a wired microphone through a 6.3mm (1/4") phone plug or a line source through an XLR male plug.
- Facility for connecting an auxiliary source through a 6.3mm (1/4") phone plug.
- Built-in digital MP3 recording, playback and Bluetooth facility. Recording or playback can be done using either a USB pen drive or a SD card. Remote for MP3 recorder is supplied along with.
- Output connector for MIX OUT, through a 6.3mm (1/4") phone socket, allowing the lectern system to be connected to external amplifiers for further amplification, if required.
- Handheld wireless microphones & gooseneck podium microphone have voice priority over all other inputs. This feature can be switched ON or OFF through a slide switch.
- Tonal adjustment can be done through cut-boost type Bass & Treble controls.
- USB outlet on podium top for charging of Mobile phones.
- Rugged & stable floor standing base. Mounting clamps are provided for fixing the product to the floor.
- Operates on 240V AC 50Hz mains supply.
- For assembly instructions see pages 5 & 6.

• Instructions for Product Assembly

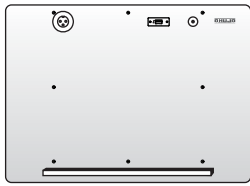

Podium Top

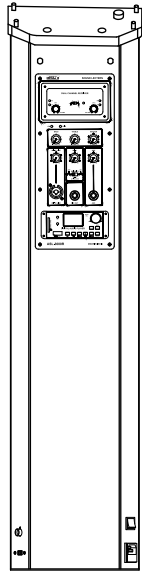

Lectern Column

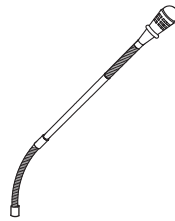

Gooseneck Microphone

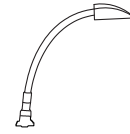

Gooseneck Light



02 nos. Antenna

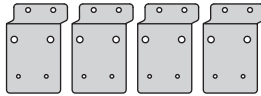

04 nos. Mounting Clamps

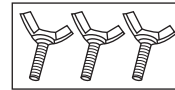

03 nos. Fly Bolt

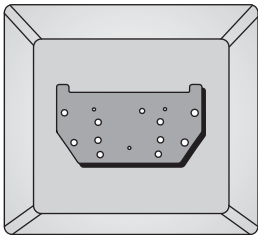

Bottom Stand

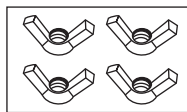

04 nos. Fly Nuts

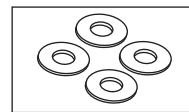

04 nos. Washers

STEP-1: Fixing of mounting clamps to the bottom stand (use mounting clamps only if floor mounting is required).

- i) Unscrew 04 nos. of rubber base feet* and 04 nos. of black screws from the bottom stand.

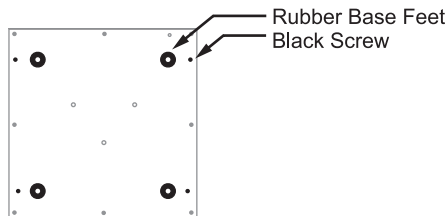

- ii) Take a mounting clamp, place it on the bottom side of the bottom stand and then tighten it with the black screw and screw of the rubber base feet.
- iii) Similarly, remaining three mounting clamps should be fixed to the bottom stand.

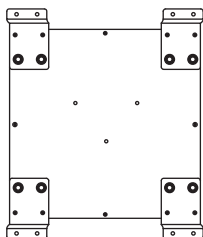

STEP-2: Fixing of Lectern Column to the bottom stand.

- i) Place the lectern column into the matching slot available in the bottom stand.
- ii) Tighten the bottom stand to the lectern column through 03 nos. of fly bolts, from bottom side of the stand.

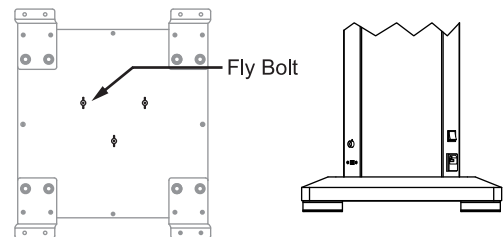

STEP-3: Fixing of Podium Top to the Lectern Column

- i) Place the podium top over the upper end of the lectern column so that the podium top slopes towards the rear side (where controls & USB module are fitted).
- ii) Tighten it by using 04 nos. of washers and 04 nos. of fly nuts.

*Keep rubber base feet for future use.

• Instructions for Product Assembly

- iii) Connect the 8-pin female connector, coming out of the podium top, to the 8-pin male connector which is fitted on the top end of the PA Lectern System.

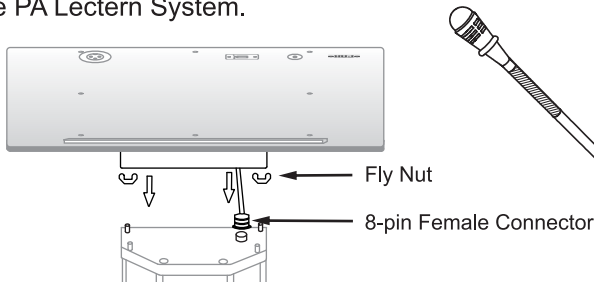

STEP-4: Fix 02 nos. of antenna in their respective connectors.

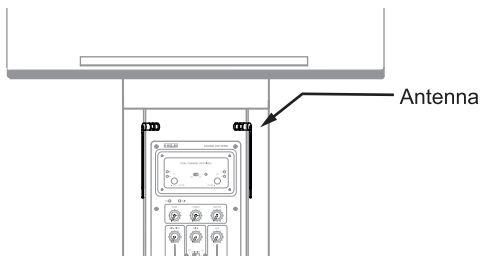

STEP-5: Fix the gooseneck condenser microphone and podium gooseneck light in their respective connectors available on the podium top.

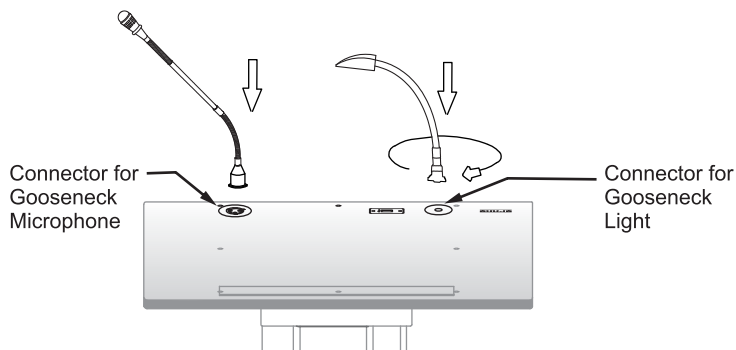

NOTE: Before switching ON, plug the AC cord in the AC socket of lectern column and connect the other end to a AC mains socket. Switch ON the power switch at lower end of the lectern column. A suitable 4Ω/8Ω speaker system can be connected to the external speaker terminal, if an external speaker is required. Other input signal sources like microphone, CD player and USB pen drive can be connected for performing desired operations.

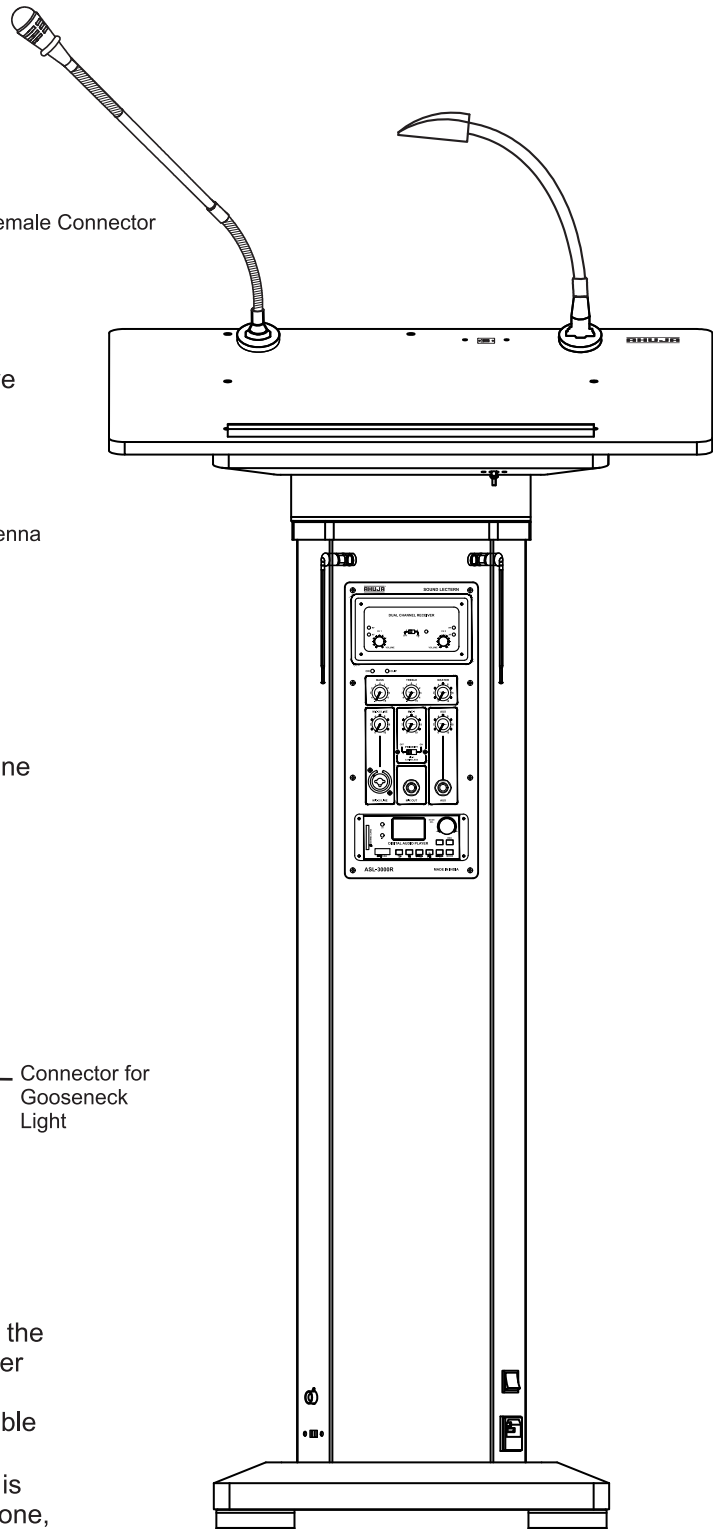

• Various Parts of Lectern System & their Functions

1. **Gooseneck Microphone:** This detachable gooseneck microphone is plugged into the female XLR socket provided on the podium top.
2. **USB Charging Outlet:** Provides 5V 1A DC output for ease of charging Mobile phones.
3. **Gooseneck Lamp:** This gooseneck LED lamp is easy to install with the circular connector, provided on the podium top.
4. **ON/OFF switch for Gooseneck Lamp:** This switch is located on the bottom side of the podium top (see adjacent figure) which can be used to switch the gooseneck lamp ON or OFF.
5. **Telescopic Antenna for Channel 1:** This collapsible antenna should be kept in fully stretched position when the wireless microphone of channel 1 is in use.
6. **Frequency Sticker for Channel 1**
7. **Telescopic Antenna for Channel 2:** This collapsible antenna should be kept in fully stretched position when the wireless microphone of channel 2 is in use.
8. **Frequency Sticker for Channel 2**
9. **Dual Channel Receiver Module:** Refer page no. 8.
10. **Amplifier Inputs & Controls Module:** Refer page no. 8.
11. **Digital Recorder Player Module:** Refer page no. 9.
12. **Power Switch:** Push the top part of the knob to switch the lectern ON. Push the bottom part of the knob to switch the lectern OFF.
13. **AC socket with built-in fuse:** AC socket for connecting the detachable AC lead, as supplied along with. This has a built-in AC fuse of T1AL rating.
14. **Mounting Clamp:** Four numbers of floor mounting clamps.
15. **SPEAKER Selector Switch:** When this switch is kept in INTERNAL SPEAKER mode, the built-in speaker column is in operation. If it is desired to use some other passive speaker then the switch is kept in EXTERNAL SPEAKER mode. In external mode, the built-in internal speakers are disconnected. Similarly, in internal mode, the external speakers are disconnected.
16. **Connector for External Speaker :** Provided for making easy connection with an external speaker through a 6.3mm (1/4") jack plug (suitable connecting cable with jack plug is supplied).

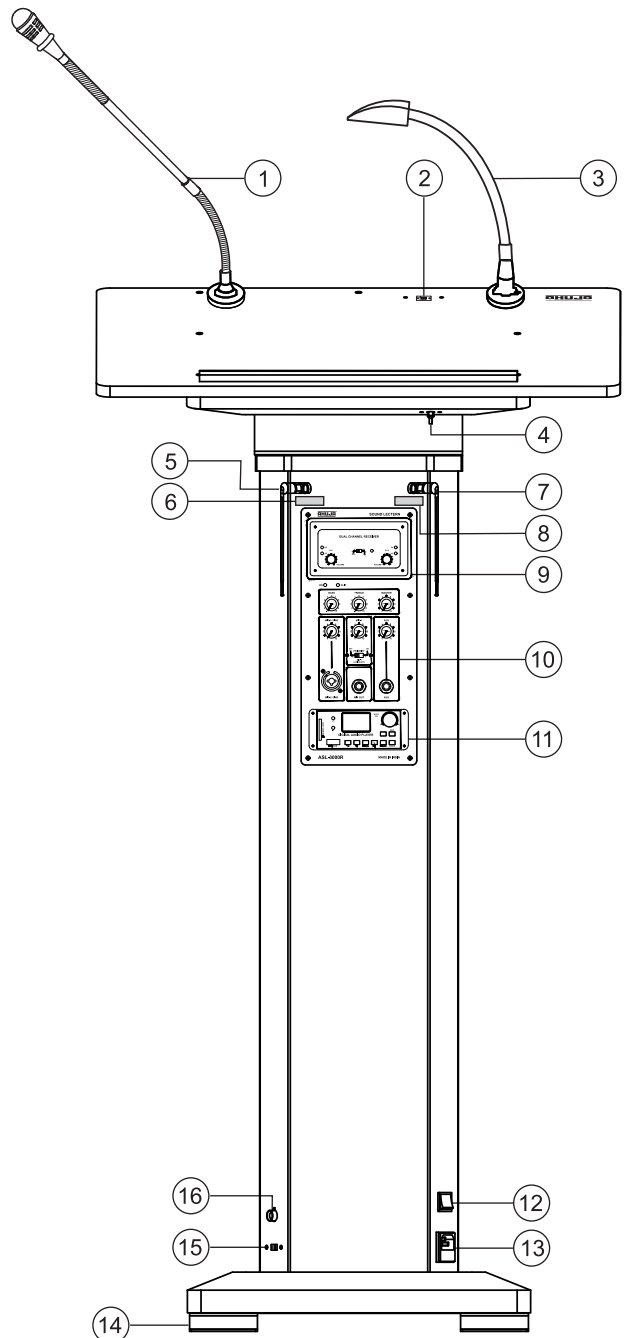

• Terminal Plate - Parts & Functions

DUAL CHANNEL RECEIVER

- Volume Control for Channel 1 Output.**
- Audio Signal LED for Channel-1:** Red LED glows when MIC of Channel-1 is switched 'ON' and few words are spoken in it.
- RF Signal LED for Channel 1:** Green LED glows when MIC of Channel-1 is switched 'ON'.
- Receiver ON/OFF switch for both Channels.**
- Power Indicator:** Red LED glows when receiver is switched 'ON'.
- RF Signal LED for Channel 2:** Green LED glows when MIC of Channel-2 is switched 'ON'.
- Audio Signal LED for Channel-2:** Red LED glows when MIC of Channel-2 is switched 'ON' and few words are spoken in it.
- Volume Control for Channel 2 Output.**

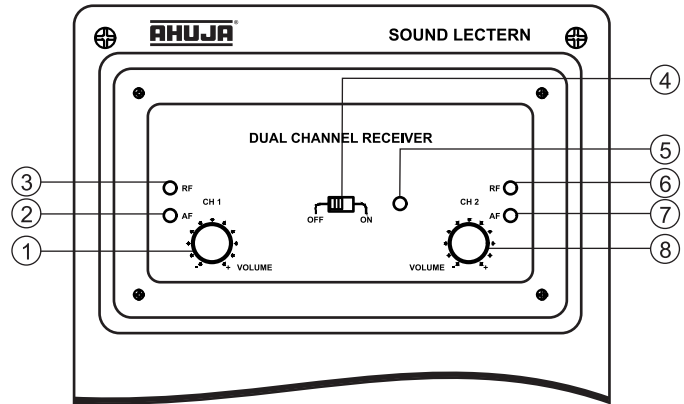

AMPLIFIER INPUTS & CONTROLS MODULE

- MIC-2/LINE Input:** This combo connector can accept unbalanced signal from a low impedance microphone through a 6.3mm (1/4") phone jack plug. Alternatively, it can accept balanced signal from a LINE level source through an XLR male plug.
- MIC-2/LINE Volume Control:** For controlling the level of the signal connected to MIC-2/LINE input connector.
- BASS Control:** For attenuating or boosting the signal level of low frequencies.
- Power LED:** Red LED glows when the AC mains supply to the lectern amplifier is switched ON.
- CLIP LED:** Orange LED glows to indicate presence of excessive signal. Occasional flickering of this LED is acceptable.
- Treble Control:** For attenuating or boosting the signal level of high frequencies.
- Master Control:** For controlling the overall level of output signal from the amplifier.
- MIC-1 Volume Control:** For controlling the signal level of the gooseneck condenser microphone which is connected on the podium top.
- AUX Volume Control:** For controlling the level of the signal connected to AUX input connector.
- Priority ON/OFF Switch:** Keep this switch in ON position to assign priority to MIC-1 & Wireless Mic (Ch.1 & Ch. 2) over all other inputs.
- AUX Input:** For accepting signal from an auxiliary source like a USB player, CD player, Audio Mixer etc.,
- MIX Output:** Unbalanced audio output is available through this 6.3mm (1/4") phone jack socket. This output is used for connecting a high power PA amplifier, Audio Interface, USB recorder etc.

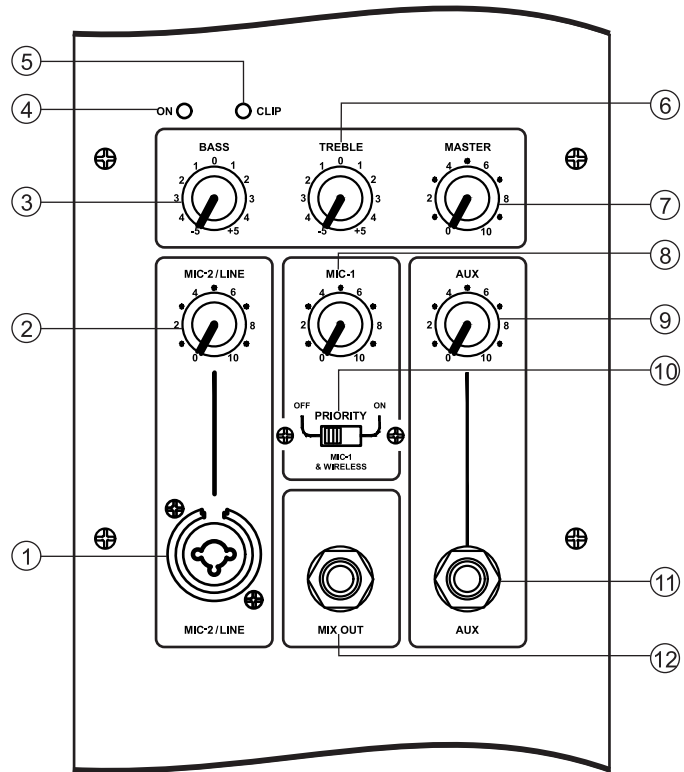

• Terminal Plate - Parts & Functions

DIGITAL RECORDER PLAYER MODULE & REMOTE CONTROL

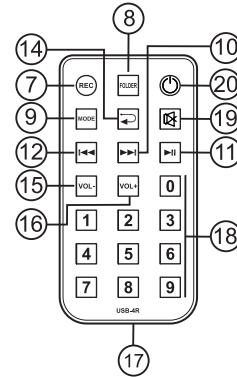
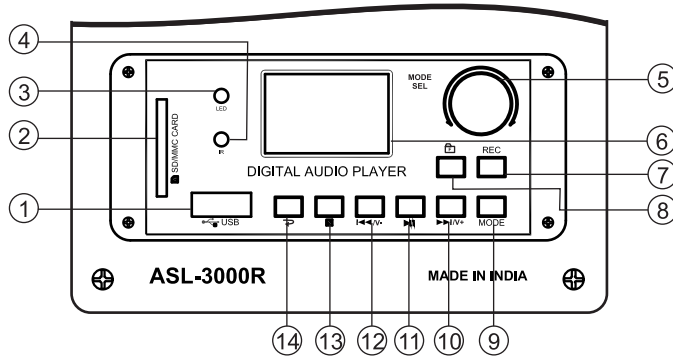

1. **USB Connector:** Insert the USB drive here. While inserting USB drive into the USB connector, hold the USB drive in such a way that hollow face of the USB drive is upwards as shown in Figure.

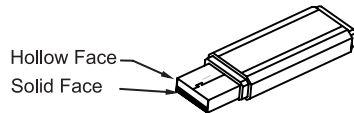

Any forceful insertion in wrong direction will damage the connector.

2. **SD/MMC Card Connector:** Insert the SD/MMC Card into its appropriate slot to play. When taking out the card, pull the card to take out.

While inserting SD/MMC card into the slot, ensure that the card is inserted in such a way that all pins are towards right & cut is facing upwards.

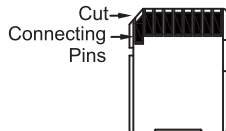

3. **LED:** This LED blinks when recording is going on.
4. **IR Sensor:** Picks up signal from the Remote control. For best results, point the Remote control towards IR sensor.
5. **Rotary Control:** Rotate clockwise or anticlockwise for selecting the option from main menu and press control knob to confirm. In case of folder option, LCD will show folders or track list. Select the desired file by rotating this knob and press to confirm. In case of USB/SD Card playback, rotate this knob to select the Next or Previous track and short press this knob to confirm. Long press will go to main menu.

By rotating this knob clockwise or anticlockwise, during playback, display will show the track name.

To play the selected track immediately, press the knob to confirm. If not pressed then it will start to play automatically the selected track after completing the current track being played.

For example track 001 is currently playing. After rotation, rotary knob cursor is on track 005 and left without pressing, then after completing track 001 it will automatically start to play track 005.

6. **LCD Display:** Momentarily displays 3 digits of the track selected to play from 001 to 999. During play, displays the time duration of the track being played.
7. **REC:** Press REC button when USB/SD Card is connected, then module will start recording in USB/SD Card. During recording short press the REC button, it will Pause the recording. Press again to resume the recording. Long press of REC button or double press of Play button during recording will immediately start playing the latest recorded file.
8. **Folder:** Press the FOLDER key and display will show track list or folder of the USB/SD card, then use Next/Prev. key or rotate the control 'M' to select the desired track and press Mode/control knob to confirm.
9. **Mode:** Press MODE key for the selection of desired function from main menu. While USB/SD/Bluetooth functions are in use for playback or recording, if the MODE key is pressed then it will stop the function & return to main menu.
10. **▶▶/V+:** During playback, short press the Next key to go to the next file or track. Long press will increase the volume level. In main menu, short press Next key to go to the next option in the main menu.
11. **▶|| PLAY/PAUSE:** Press PLAY/ PAUSE once to pause if music is already playing. Press PLAY/PAUSE again to resume playing. During recording, short press of PLAY/PAUSE will immediately start playing the recently recorded file.
12. **◀◀/V-:** During playback short pressing the prev. key will go to the prev. file/track. Long press will decrease the volume level. In main menu, short press Prev key to go to the previous option in the main menu.
13. **STOP:** Press this key to stop PLAY.

• Terminal Plate - Parts & Functions

14. ↻ **Cycle Mode:** Successive pressing of this button provides various options like REPEAT1, INTRO, NORMAL, FOLDER, REPEAT FOLDER, RANDOM and REPEAT ALL.
15. **VOL-:** To decrease volume level of MP3 player.
16. **VOL+:** To increase volume level of MP3 player.
17. **Battery Replacement:** Pull out the battery tray and replace the battery with positive electrode facing upwards as shown in fig. below. Push the battery compartment back to the close position. Use CR2025 or equivalent lithium coin cell.
18. Number key 0 to 9. To choose the track number to be played.
19. ☒ **MUTE:** Press once to mute the audio, press again to resume the audio.
20. **Power:** Press once to switch off MP3 player, press again to switch ON.

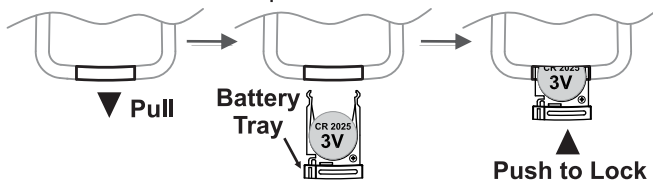

• Handheld Transmitter Controls and Features

Handheld Transmitter

- Insert 2 × 1.5V AA pencil cells in the battery compartment of each handheld transmitter by unscrewing the lower part of the transmitter body.

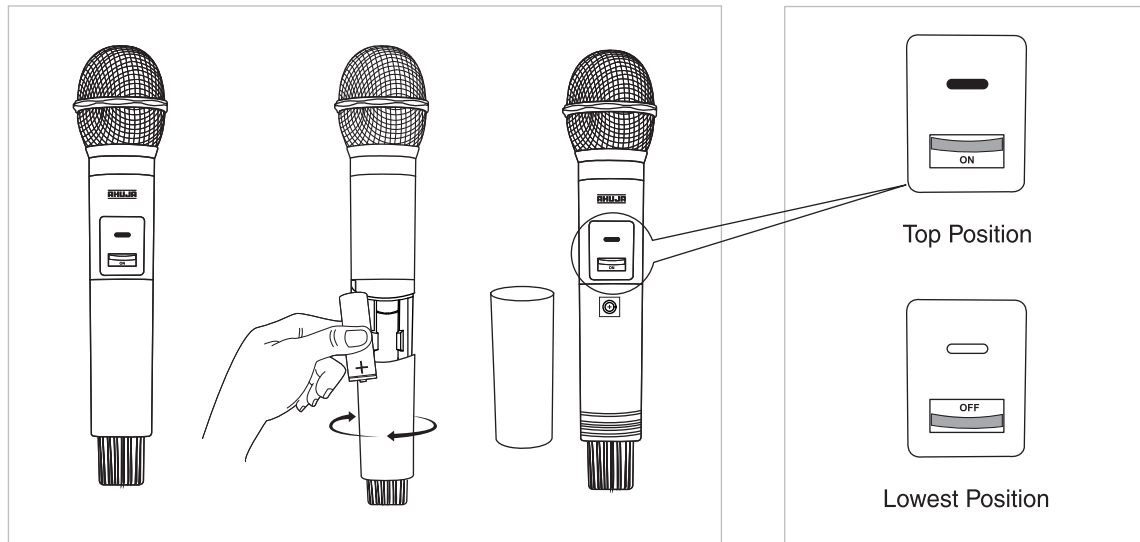

- Ensure the 2 × 1.5V AA pencil cells are inserted with correct polarity (pencil cells are supplied with).
- The transmitter has a 2-position slide switch:
- In top position, the transmitter is ON and its LED glows (GREEN in Channel 1 & RED in Channel 2). Keep the switch in top position when speaking into the handheld transmitter.
- When the switch is at the lowest position, the transmitter will be completely switched off.

• Description of Various Functions

1. **Gooseneck Microphone Function:** The gooseneck condenser microphone gets ON and its red ring LED lights up when power switch of lectern is switched ON. The gooseneck microphone grill should have a foam wind shield which minimises pop and breath noise. Speak a few words through the microphone and adjust the desired output level through MIC1 volume control on the amplifier module. If gooseneck microphone is not in use then it is recommended to keep MIC 1 volume control at minimum position.
2. **Wireless Transmitter Function:** PA lectern system is supplied with two handheld VHF wireless transmitters and a dual channel receiver is built into the lectern column. Ensure that the two antenna are fully stretched and kept away from any other reflecting surfaces and obstructions. Carry out a 'walk through' test of the wireless system to ensure that there are no drop-outs in the performing area. The output level is adjustable through respective volume controls of Ch.1 & Ch.2 in the receiver module.
3. **USB/SD Playback:** For playing pre-recorded music or messages through the lectern, insert the USB pen drive or SD/MMC card into its appropriate slot, switch the MP3 module ON, press PLAY button and operate the lectern.
4. **USB/SD Recording:** Press REC button when USB/SD Card is connected, then module will start recording in USB/SD Card. During recording short press the REC button, it will Pause the recording. Press again to resume the recording. Long press of REC button or double press of Play button during recording will immediately start playing the latest recorded file.
5. **Priority Function:** Activation of priority function is possible by keeping PRIORITY switch is ON position. Priority is assigned to gooseneck Mic & wireless mics. Ensure to keep the switch in OFF position if priority function is not desired.
6. **External Speaker:** The built-in speakers of the lectern column can be replaced by external speaker system of 4ohm to 8ohm impedance. To do so, put speaker selector switch in External Speaker position. Connect a suitable speaker to the socket for external speaker and adjust BASS and TREBLE controls to achieve desired tonal response.

• Pairing of Bluetooth Device

Switch ON the lectern ASL-3000R and select the Bluetooth option either by pressing MODE button or rotary control on MP3 module.

To play the MP3 programme from mobile phone or laptop in bluetooth mode, the PAIRING of mobile phone/laptop & the unit is necessary.

Normally the following general instructions are followed :

For pairing of devices, switch ON the Bluetooth option in mobile phone or laptop.

The mobile phone or laptop starts searching for the new Bluetooth device. The moment new device by name AHUJA appears on the mobile phone or laptop, select the new device i.e. AHUJA and press OK or else allow as it appears on mobile phone or laptop . The display on the unit shows BT mode connected and the system is now ready to use.

In some mobiles, it asks for a code to allow access. Press 0000 and follow the steps, like pressing "OK", "Allow once", "Allow always" etc. and make the device ready for use.

Select the MP3 programme from mobile phone or laptop and press PLAY. The same song starts playing on the Ahuja Digital Player/Recorder. We can SELECT Volume, FF, Rewind, Play/Pause function either from keys on the unit or through Remote Control.

• Specifications

AMPLIFIER	
Power Output	90 Watts Max; 60 Watts Rated
Input Channels	Mic-1(Gooseneck Mic): 8mV, Mic-2: 5mV, Line: 100mV, Aux : 200mV
Frequency Response	50-16,000Hz
Tone Control	Bass ± 5 dB at 100Hz, Treble ± 5 dB at 10kHz
MIX Output	775mV
Digital Player	Mp3 recorder player with USB, SD, MMC card & Bluetooth
USB Charger Outlet	DC 5V, 1A
External Speaker Impedance	4 Ω to 8 Ω
Power Supply	AC 220-240V, 50/60Hz
Power Consumption	AC 100VA
Dimensions	W580 \times H1150 \times D420 mm
Weight	18.20 kg approx.
MICROPHONE (Handheld Transmitter)	
Microphone element	Dynamic, Cardioid
RF Output Power	15mW (max.)
Frequency Response	50 - 15,000Hz
Power Requirement	3V (2x1.5V AA Pencil Cells)
Current Consumption	≤ 100 mA
Dimensions	$\varnothing 55 \times L248$ mm
Weight (w/o battery)	180g.

- Design and Specifications are subject to change without notice owing to continuous product upgradation.
- Technical specifications are subject to production tolerances.

• Parts of PA Lectern System

Podium Top	1 no.	AC Power Cord	1 no.
Bottom Stand	1 no.	Remote Control	1 no.
Handheld Wireless Microphone	2 nos.	Mounting Clamps	4 nos.
Gooseneck Condenser Microphone (with Foam Windshield)	1 no.	Fly Bolt	3 nos.
Gooseneck Light	1 no.	Fly Nuts	4 nos.
Antenna	2 nos.	1.5V AA Pencil Cells	4 nos.
Connecting Cable (with 6.3mm jack plug)	1 no.	Operation Manual	1 no.

Design and Specifications are subject to change without notice owing to continuous product up-gradation. Technical specifications are subject to production tolerances.

We cannot be held responsible for printing errors, should they occur. **AHUJA** is a registered trademark of Ahuja Radios in India and other countries.

© Copyright Ahuja Radios, 2022. All rights reserved. Any unauthorized reproduction or use of logos, images or design elements is strictly prohibited by law.

No part of this compilation may be reproduced in any manner or translated without written permission.

AHUJA RADIOS

215, Okhla Industrial Estate, New Delhi-110020, INDIA

C-45, Phase-II, Noida-201305 (UP) INDIA • 3, Okhla Industrial Estate, New Delhi-110020 INDIA

Tel.: +91-11-26831549, 41612474 Fax: +91-11-26847287 E-mail: ahuja@ahujaradios.com

Website: www.ahujaradios.com